

Model M - Multi-Jet Magnetic Water Meter

- **Applications**

For domestic, agriculture and industrial use.

- **Available Sizes**

1/2" - 1 1/4", 2" (15mm - 30mm, 50mm).

- **Standards**

ISO 4064, AWWA, EC, MID, etc

Features:

- Only one moving part - the impeller - in contact with the water for minimum wear and utmost reliability.
- Magnetically driven sealed registers. Stainless steel/glass encapsulated option is unconditionally guaranteed against fogging.
- Wide selection of dial configurations (3 pointers; central pointer) and units of measurements.
- Optional Electrical Output: EV, EF, Dialog 3G, DPE, MPE.



Technical Specifications

Maximum Working Pressure	10 bar (16 bar optional)
Maximum Working Temperature	50°C 90°C – For HOT water
Body Option sizes 1/2" - 3/4"	Corrosion proof copper alloy Highly reinforced composite material
Coupling threads	BSP, NPT



M type dial

Model M - Multi-Jet Magnetic Water Meter

Dimensions

Model		M15 (short)	M15	M20	M25	M30	M35
Nominal size	(mm)	15	15	20	25	30	50
	(inch)	1/2	5/8	3/4	1	1 1/4	2
L – Length without couplings (mm)		165	190	190	260	260	300
L ₁ – Length with couplings (mm)		260	285	285	375	375	460
B – Width (mm)		95	95	95	105	105	160
H – Height (mm)		108	108	108	108	108	190
Weight (kg)		1.9	2	2	2.8	2.8	10.3
Weight with couplings (kg)		2.1	2.2	2.3	3.3	3.45	11.7
Weight (plastic body) (kg)		0.55	0.56	0.60			

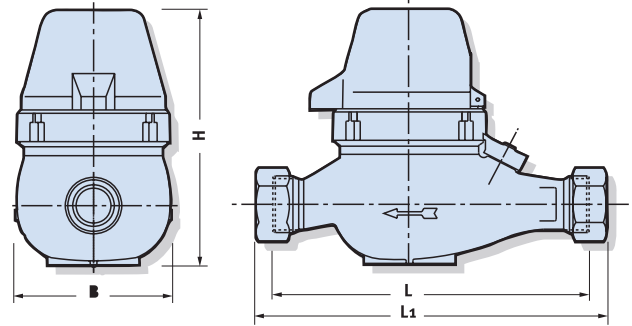

Performance data:

Model	Nominal size (inch)	Q _{max} Maximum flowrate (m3/h)	Q _n Nominal Flowrate (m3/h)	Q _n Transitional Flowrate (m3/h)	Q _{min} Minimum Flowrate (m3/h)	Maximum register capacity (m3)	Smallest readable unit (liter)	Accuracy between Q _{max} & Q _t	Accuracy between Q _t & Q _{min}
M15	1/2"	3	1.5	120	30	10 ⁵	0.1	±2%	±5%
M20	3/4"	5	2.5	200	50	10 ⁵	0.1		
M25/7	1"	7	3.5	280	75	10 ⁵	0.1		
M25/10	1"	10	5	400	100	10 ⁵	0.1		
M30	1 1/4"	12	6	480	120	10 ⁵	0.1		
M50	2"	30	15	3000	450	10 ⁶	1		

Accuracy Curve

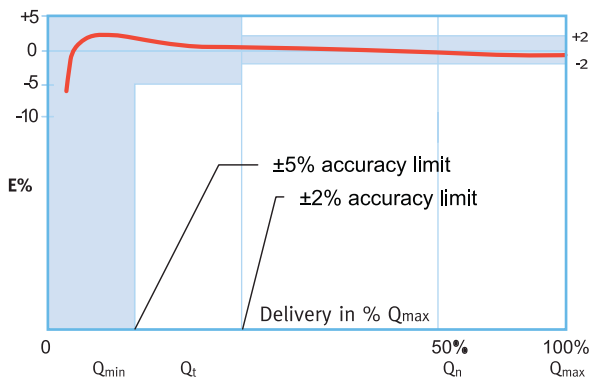

Head Loss Curve

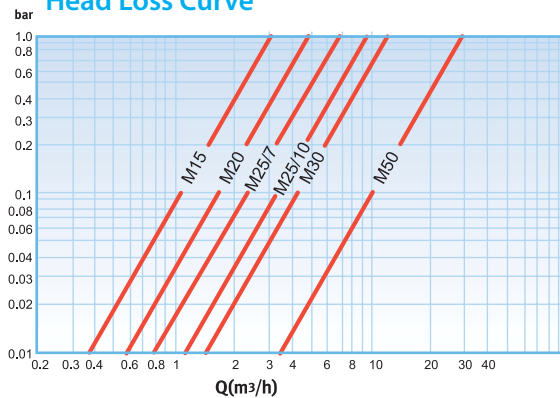

Installation Requirements

- The Meter should be installed in horizontal position dial face up.
- Pipeline must be flushed before installation.
- The meter should be constantly full of water.